

PANEL DETAIL AT A  
SCALE 3:1

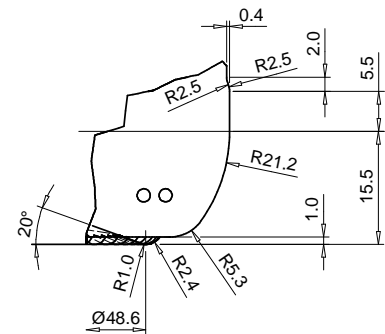

INSWEEP & STACKING RING DETAIL  
SCALE 2:1

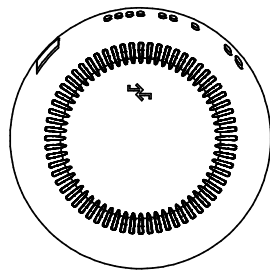

VIEW ON BASE  
SHOWING EMBOSSED MARKINGS  
STANDING AREA EMBOSSED  
WITH BAR STIPPLE  
FORMING STACKING RING



## 1 lb Jam Jar

SCALE 1:1 (A2)	DESIGNER DA	<b>1 lb Jam Jar</b>		NECK REF. No <b>2K9/C1</b>
DATE 11/10/10	CHECKED AH			
NECK FINISH 63 TWIST OFF	REV.N A) DOT CODE & MOULD No DETAIL ADDED	(DNA) DA 10/07/12		DRAWING No <b>B9132A</b>
APPROX. WEIGHT 203 g				DIMENSIONS IN MILLIMETRES
FILL POINT 0 down				
CAPACITY TO FILL POINT 380.0 ml				
CAPACITY TOLERANCE (BULK) ± 4.0 ml				
CAPACITY BRIMFULL 380.0 ml				
Note: Filling point measured from top centrally inside neck unless otherwise specified.	Untoleranced dimensions are for mould making guidance only and should be regarded as approximate.	This drawing and the design of the article in the drawing are each the property of Beatson Clark plc, Rotherham. Neither the drawing nor the design shall be copied without the previous written authority of Beatson Clark plc.		